

T1 EVO Setup Guide



Getting started:

- Make sure to have enough space to unpack your turntable.
- Always unpack and set up in a clean environment.
- Please Do **NOT** throw away the packaging! If you need a service or want to return your product, please send them in the original packaging including all inserts. In case of any damage in another packaging your dealer cannot guarantee a full refund.
- Complete manual: <https://www.project-audio.com/en/product/t1-evo>

1 Remove dust cover from the box.

2 Take the small boxes from the carton.

3 Unpack all items.

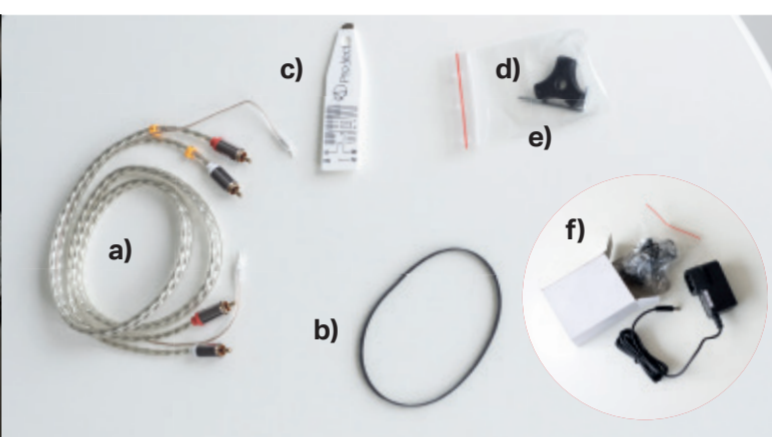

- a) Connect it E (RCA cable)
Detachable cable only included with T1 EVO Phono & BT
- b) Drive belt
- c) Stylus pressure gauge
- d) Adapter for 7" singles
- e) Allen key
- f) Power supply

4 Lift the wrapped turntable out of the box.

5 Remove the protection covering.

6 Unpack the felt mat and the platter from the bottom of the packaging.

7 Put the drive belt on the pulley & sub-platter.

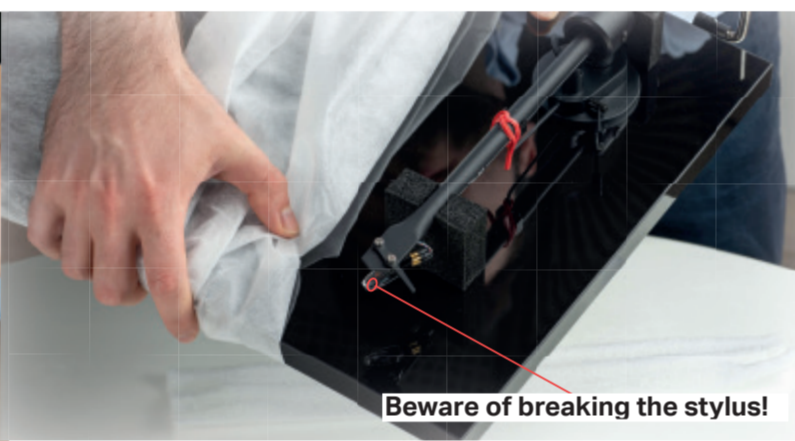

8 Put the platter & felt mat on the turntable.

9 Remove the protective tonearm inlays.

10 Remove tonearm twist tie.

11 Connect to your hifi-system and enjoy your music!

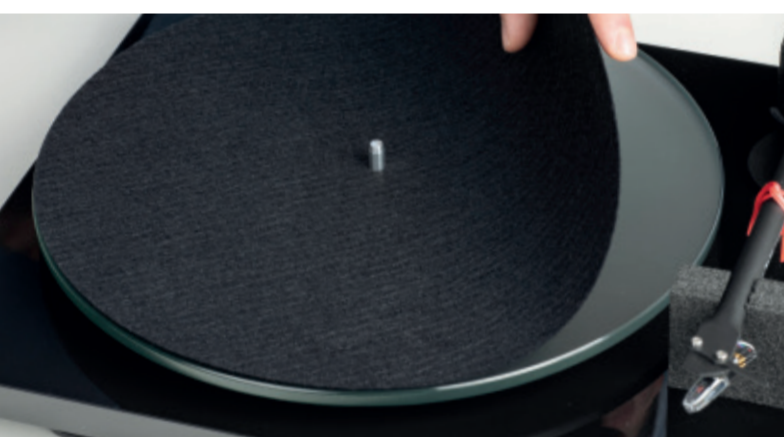

Beware of breaking the stylus!

Remove stylus protector before playback!

Speed change on left side.

How to connect your model and possible setups:

T1 EVO

Connect to any amp with integrated phono amplifier or use an external phono preamp.
Pre-mounted Connect it E (RCA cable) included.
Possible set: Pro-Ject Speaker Box 5 S2 (bookshelf speaker) and Pro-Ject MaiA S3 (stereo integrated amplifier).

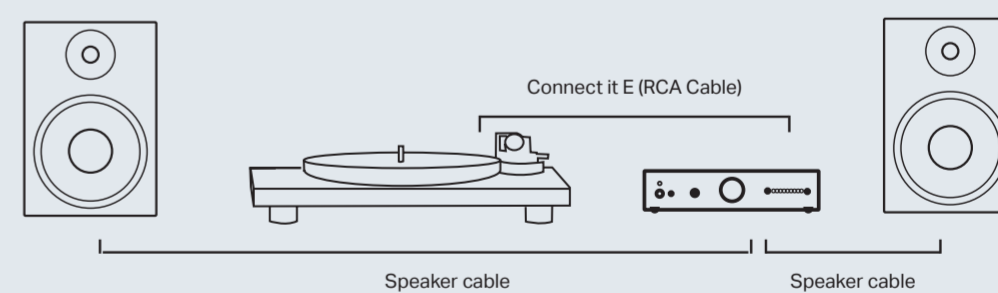
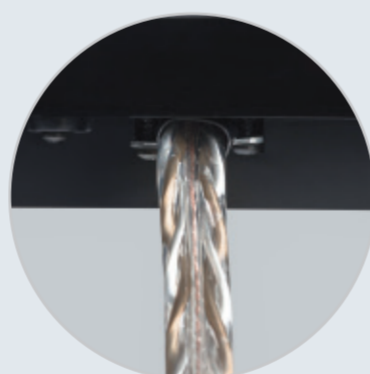

T1 EVO Phono

Select **Line Out** to connect to an amplifier without a phono stage.
Select **Phono Out** if you have an amplifier with a phono stage.
Possible set: Pro-Ject Speaker Box 5 S2 (bookshelf speaker) and Pro-Ject Stereo Box S3 BT (stereo integrated amplifier).

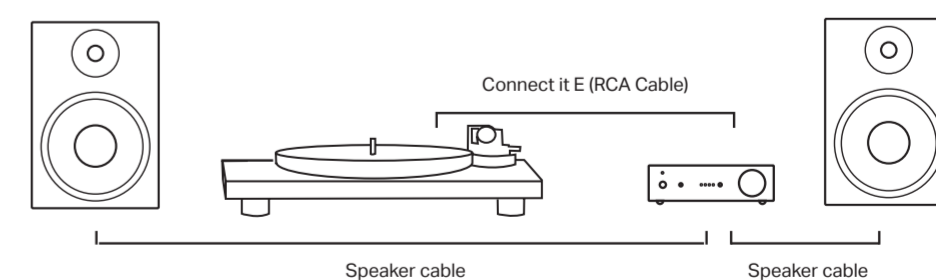

T1 EVO BT

Use **Line Out** to connect to an amplifier without a phono stage. Use **Phono Out** if you have an amplifier with a phono stage. Enjoy the warmth of vinyl with the comfort of wireless technology.

Possible set: Pro-Ject Speaker Box 5 S2 (bookshelf speaker) and Pro-Ject Stereo Box S3 BT (stereo integrated amplifier).

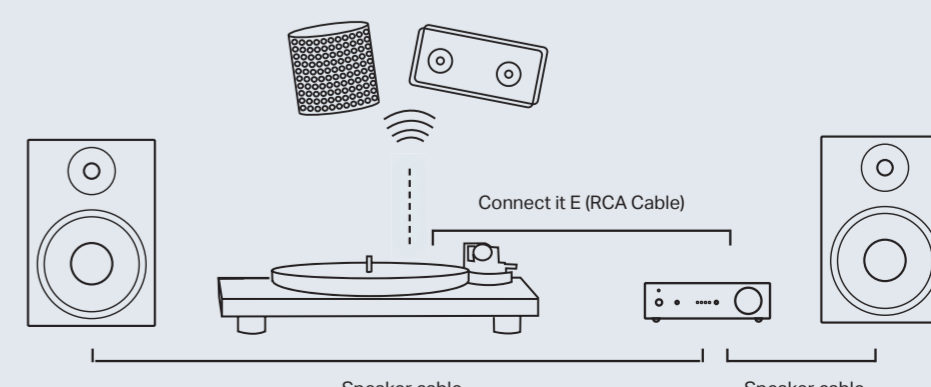

T1 EVO

Pro-Ject
AUDIO SYSTEMS



Need help?
Feel free to contact us. We have experienced partners all over the world. Find your dealer here:
www.project-audio.com/en/find-a-dealer/

Service

Should you encounter a problem which you are not able to alleviate or identify despite the above information, please contact your dealer for further advice. Only when the problem cannot be resolved there should the unit be sent to the responsible distributor in your country. Warranty repairs will only be affected if the unit is returned correctly packaged. For this reason we recommend keeping the original packaging. Never return a record player without making sure that it is safely disassembled and correctly packaged in the original packaging. Please remove these parts and pack them separately: lid, counterweight, anti-skating weight and belt. Fit the cartridge protection cap and the transport lock for the tonearm tube, prior to carefully packaging the record player.

Warranty

The manufacturer accepts no responsibility for damage caused by not adhering to these instructions for use and/or by transportation without the original packaging. Modification or change to any part of the product by unauthorized persons, release the manufacturer from any liability over and above the lawful rights of the customer.

Warranty: Terms and Conditions

- A warranty is valid only for products purchased from an authorized Pro-Ject Audio Systems retailer or dealer.
- This warranty offer is limited to the repair of the equipment (which could be a repair or replacement at our discretion, neither of which affects your original warranty).
- Neither transportation or any other costs, nor any risk for removal, transportation and installation of products is covered by this warranty.
- A warranty is only valid for the original owner. It is not transferable.
- To validate your warranty, you will need to provide the original sales invoice or other proof of ownership and date of purchase.
- Warranty must be claimed within two years of purchase from an authorized dealer. After this period of time, the warranty will expire.
- The legal warranty obligation exists in addition to this warranty and is not limited by this warranty.

A Pro-Ject Audio Systems warranty relates to claims of defects in materials and/or workmanship at the time of purchase. It does not cover:

- Deterioration of component parts, the nature of which is to become worn or depleted with use, such as batteries and headphone ear pads, drive belts and cartridges.

- Damages caused by incorrect installation, connection or packing.
- Damages caused by any use other than the correct use described in the user manual, negligence, modifications, or use of parts that are not made or authorized by Pro-Ject Audio Systems.
- Damages caused by faulty or unsuitable ancillary equipment.
- Damages caused by accidents, lightning, water, fire heat, war, public disturbances or any other cause beyond the reasonable control of Pro-Ject Audio Systems and its appointed distributors.
- Products where the serial number has been altered, deleted, removed or made illegible.
- Repairs or modifications that have been executed by an unauthorized person.

Commercial Use

Faults caused due to using domestic products in commercial environments or on commercial scales are not covered by warranty. This turntable is intended for domestic use only. Using them for business applications are done so at your own risk.

Pro-Ject Audio Systems is a Registered Trademark of H. Lichtenegger.

This guide was produced by: Pro-Ject Audio Systems
Copyright © 2024. All rights reserved.

The information was correct at the time of going to press. The manufacturer reserves the right to make changes to the technical specification without prior notice as deemed necessary to uphold the ongoing process of technical development.

Qualcomm aptX is a product of Qualcomm Technologies, Inc. and/or its subsidiaries. Qualcomm is a trademark of Qualcomm Incorporated, registered in the United States and other countries. aptX is a trademark of Qualcomm Technologies International, Ltd., registered in the United States and other countries.